

**Dry non-fillable gauge for ammonia refrigeration applications**  
**Chrome plated steel case, stainless steel internals and steel socket**

### SPECIFICATIONS

<b>Dial</b>	2 1/2" (63 mm), 4" (100 mm)
<b>Case</b>	Chrome plated steel case, dry non-fillable
<b>Wetted Parts</b>	Steel socket, stainless steel Bourdon tube
<b>Ranges</b>	30/0/150 psi/-40/0/80° F 30/0/300 psi/-40/0/120° F
<b>Bezel</b>	Removable lens
<b>Lens</b>	Plastic, twist-off
<b>Pointer</b>	2 1/2" - adjustable, black aluminum 4" - without adjustment, black aluminum
<b>Connection</b>	Lower mount 1/4" NPT
<b>Scale</b>	Standard: psi/° F temperature equivalent
<b>Accuracy</b>	3-2-3% of span ASME B40.1 Grade B
<b>Ambient Temp</b>	Dry = -40° F to 180° F



*Design meets or exceeds ASME B40.100 pressure gauge standard.*

5

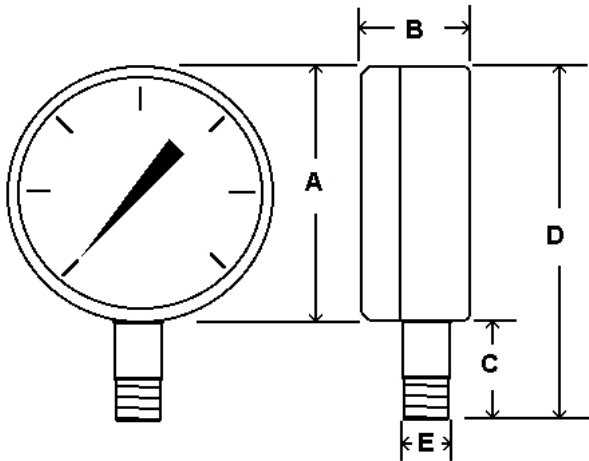

Dial	Unit	A	B	C	D	E
2 1/2"	In.	2.87"	1.14"	2.65"	0.84"	1/4" NPT
	mm	73	29	67	21	
4"	In.	4.21"	1.35"	3.89"	1.03"	1/4" NPT
	mm	107	34	99	26	

### AVAILABLE OPTIONS\*

- Custom Dial
- Special Connection Size
- Other Ranges

\*Lead times/minimums may apply

### APPROXIMATE SHIPPING WEIGHTS/ BOX QUANTITIES

Dial Size	Est. Unit Wt.	Box Qty
2 1/2"	0.3 lbs (0.14 kg)	50
4"	0.55 lbs (0.24 kg)	50