

KR - Common Replacement Part List



Item	Description	Part Number
1	Motor Options	
	SP 460V	E206446
	PSC 115V	E206447
	PSC 230V	E206448
	EC 115V	E410373001
	EC 208/230V	E410374001
2	Motor Mount	
	MOTOR MOUNT	E316578
3	Fan Blade Options	
	LOW NOISE FAN BLADE EC	E410387001
4	LOW NOISE FAN BLADE PSC	E316580
5	Fan Guard Options	
	PLASTIC	E316655
	WIRE	E316579
	Header Cover Options	
6	HEADER COVER FRONT	E108007
7	HEADER COVER BACK	E108031
	RB Cover Options	
8	RB COVER FRONT	E108009
9	RB COVER BACK	E108010
10	Hanger Options	
	HANGER	E108013
11	Fan/Top Panel Options	
	1 FAN	E108001
	2 FAN	E108002
	3 FAN	E108003
	4 FAN	E108004
	5 FAN	E108005
	6 FAN	E108006
12	Drain Pan Options	
	1 FAN	CE107073
	2 FAN	CE107075
	3 FAN	CE107076
	4 FAN	CE107077
	5 FAN	CE107078
	6 FAN	CE107079
13	Wiring Harness Options	
	1 FAN 115-230V	E206449
	2 FAN 115-230V	E206450
	3 FAN 115-230V	E206451
	4 FAN 115-230V	E206452
	5 FAN 115-230V	E206453
	6 FAN 115-230V	E206454
	1 FAN 460V	E206518
	2 FAN 460V	E206519
	3 FAN 460V	E206520
	4 FAN 460V	E206521
	5 FAN 460V	E206522
	6 FAN 460V	E206523
14	Aluminum Drain Fitting Options	
	ALUMINUM DRAIN FITTING	E206462
15	Aluminum Conduit Coupling Options	
	ALUMINUM CONDUIT COUPLING	E206463

Item	Description	Part Number
16	Drain Fitting Gasket Options	
	DRAIN FITTING GASKET	E206464
17	Thermostats	
	DEFROST TERM (14T32)	E206100
	HEATER SAFETY (14T21)	10956
	FAN DELAY (14T31)	E201818
	KP-73	E205004
18	Pan Heaters	
	1 FAN 115V	E201883
	1 FAN 230V	E201884
	2 FAN 115V	E201889
	2 FAN 230V	E201890
	3 FAN 115V	E201892
	3 FAN 230V	E201893
	4 FAN 115V	E201895
	4 FAN 230V	E201896
	5 FAN 115V	E201898
	5 FAN 230V	E201899
	6 FAN 115V	E201901
	6 FAN 230V	E201902
19	Drain Pan Heater Bracket	
	DRAIN PAN HEATER BRACKET	E107025
20	Face Heater Support Clip	
	FACE HEATER SUPPORT CLIP	E102007
21	Coil Heater Options	
	230V 1 FAN	E206455
	230V 2 FAN	E206457
	230V 3 FAN	E206458
	230V 4 FAN	E206459
	230V 5 FAN	E206460
	230V 6 FAN	E206461
22	Expansion Valve Options	
	SBFVE-A-ZP40	E205324
	SBFSE-A-ZP	E205360
	EGVE-2-ZP40	E205735
	EGVE-1 1/2-ZP40	E205792
	EGVE-1-ZP40	E205821
	EGVE-3/4-ZP40	E205838
	EGVE-1/2-ZP40	E205854
	SBFSE-B-ZP	E205920
	SBFVE-B-ZP40	E205927
	SBFVE-AA-ZP40	E205973
	EGVE-3-ZP40	E206058
	EGSE-2-ZP	E206165
	SBFSE-AA-ZP	E206169
	EGSE-1-ZP	E206178
	EGSE-1/2-ZP	E206212
	EGSE-1/4-ZP	E206235
	EGSE-1½-ZP	E206317
	SBFVE-C-ZP40	E206600
	SBFSE-C-ZP	E311124
23	Long Throw Adapter Options	
	GALVANIZED	E202347

REVISIONS				
CHANGE ORDER	REV	DESCRIPTION	DATE	APPROVED
-	1	PRERELEASED	31-Jul-09	-

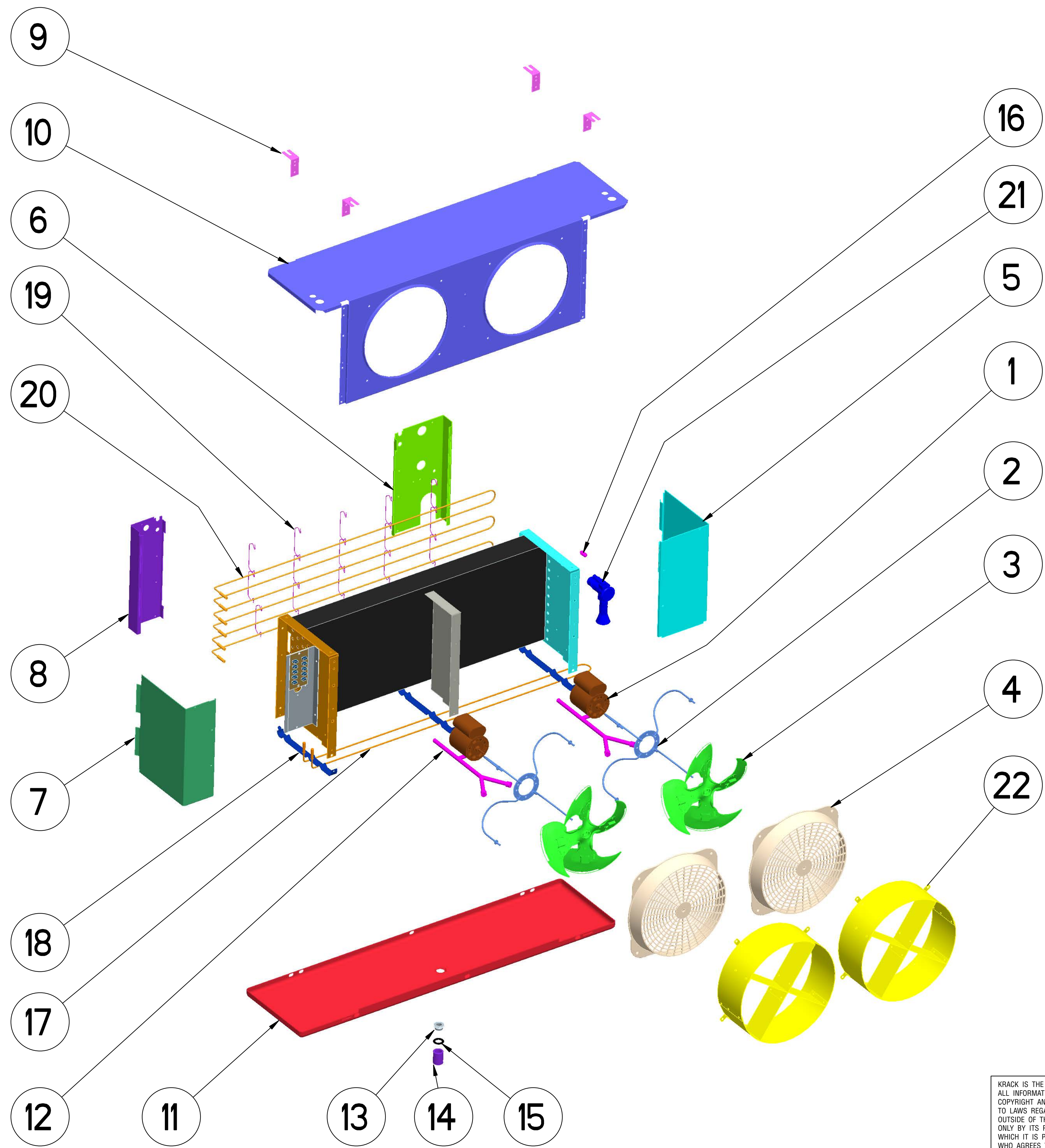

22	LONG THROW ADAPTERS
21	EXPANSTION VALVE
20	COIL / DP HEATERS (ELECTRIC DEFROST)
19	FACE HEATER SUPPORT CLIP
18	DRAIN PAN HEATER BRACKET
17	PAN HEATERS
16	THERMOSTATS
15	DRAIN FITTING GASKET
14	ALUMINIUM CONDUIT COUPLING
13	ALUMINIUM DRAIN FITTING
12	WIRING HARNESS
11	DRAIN PAN
10	FAN / TOP PANEL
9	HANGER
8	RB COVER BACK
7	RB COVER FRONT
6	HEADER COVER BACK
5	HEADER COVER FRONT
4	FAN GUARD
3	FAN BLADE
2	MOTOR MOUNT
1	MOTOR
ITEM NO	DESCRIPTION

LIST OF MATERIALS	
KRACK	
TITLE	
KR UNIT COOLER	
SIZE	DWG NO
D	E109400
SCALE	SHEET
0.038	1 OF 1

KRACK IS THE SOLE OWNER OF THIS DRAWING AND ALL INFORMATION IN IT, WHICH ARE PROTECTED BY COPYRIGHT AND OTHER LAWS AND MAY BE SUBJECT TO LAWS REGARDING EXPORTING INFORMATION OUTSIDE OF THE U.S. THIS DRAWING MAY BE USED ONLY BY ITS RECIPIENTS FOR THE PURPOSE FOR WHICH IT IS PROVIDED AND ONLY BY THE RECIPIENT, WHO AGREES THAT IT WILL NOT, WITHOUT KRACK'S PRIOR WRITTEN PERMISSION: 1) DISCLOSE NOR USE THIS DRAWING OR THE INFORMATION IN IT EXCEPT AS SPECIFIED ABOVE; OR 2) MAKE ANY COPIES OF OR EXTRACTS, REVISIONS, OR UPDATES FROM THE DRAWING. ALL COPIES MUST BE RETURNED TO KRACK UPON COMPLETION OF THE WORK FOR WHICH THEY HAVE BEEN PROVIDED OR UPON ANY EARLIER REQUEST.

UNLESS OTHERWISE SPECIFIED DIMENSIONS ARE IN INCHES. INTERPRET DIM AND TOL PER ASME Y14.5M - 1994		CAD GENERATED DRAWING. DO NOT MANUALLY UPDATE.	
THIRD ANGLE PROJECTION	DRAWN	RKS	DATE
	CHECKED	-	31-Jul-09
FINISH	APPROVED	-	-
-	ENG APPVL	-	-