

ITEM	P/N	DESCRIPTION	QTY
1	H16099J	HEAD 16.00 OD 0.099M CS SA414G 2:1 SE JOG	2
2	V10094-SL	SHELL BURNT 0.125 CS SA414-G 29.25 X 16.00 OD	1
3	S112801	HINGED CLOSURE 6.625 OD 300# 0.438 THICK SA516-70 W/ VITON O-RING W/ MTR, U2 @ 400F (FULL VAC)	1
4	F102001	WELD FLG 2.000 NPT CS SA181-70 RAD 958 O/R	2
5	F100500	WELD FLG 0.500 NPT CS SA181-70 FLAT 253	4
6	S101652	BAFFLE 7GA A1011CS-B x 2.000 x 4.438 x 7.500	1
7	LL2898	LUG 0.406 X 2.687 X 2.000 A105 LIFT (4850# MAX) (4:1)	2
8	S112769	SKIRT ASY 10GA A1011CS-B 12.00 OD W/4.000 CLR FOR 16.00 OD TANK	1
8.1	S112769-1	SKIRT 10GA A1011CS-B 5.375 X 12.00 OD FOR 16.00 OD TANK	1
8.2	S101519-P	CLIP, 10GA A1011CS-B 2.000 x 2.000 x 2.875 PURCHASED	4
9	V10094-NP	NAME PLATE FOR V10094 A1011CS-B	1

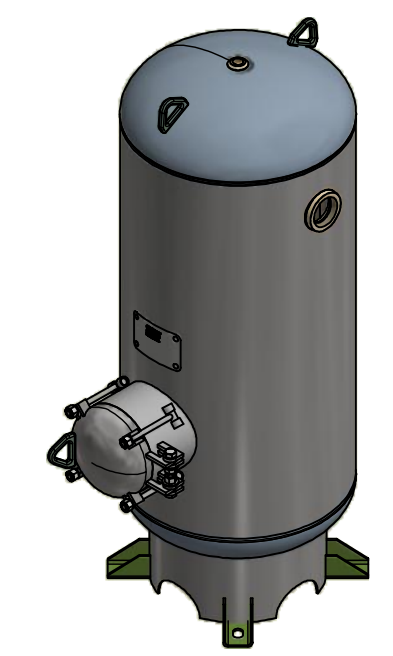

**SHELL CUT SIZE IS REFERENCE ONLY
 **CPLG & FITTING 0.50 EXT PROJ TYP
 **HEAD THICKNESS SHOWN IS SPECIFIED MINIMUM
 **RADIUS INSIDE PROJECTED EDGES OF NOZZLES 1/8" MIN
 **SEE PAGE 2 FOR FINISH
 **ALL DIMS IN INCHES UNLESS NOTED OTHERWISE
 **IMPACT TEST EXEMPT PER UG 20(f)
 16" X 38" 150/FV# VERTICAL-VACUUM TANK
 NOTES

TRAVELER REQUIRED <input checked="" type="checkbox"/>		FIXTURE REQUIRED <input type="checkbox"/>		IF YES THEN FIXTURE # _____	
RELEASED TO PRODUCTION		TOLERANCES ARE PER EN1370 STEEL FAB STANDARD TOLERANCES UNLESS OTHERWISE SPECIFIED		DESIGN & CALCULATIONS COMPLY WITH ASME CODE SECTION VIII, DIV1. LATEST EDITION	
SALES ORDER#		QTY:		SPVGG STOCK	
RELEASE DATE:		NB/SERIAL#		ENG. APPL / DATE BW - 1/15/2020	
HEAD THK: .099" MIN C.A.: --- MAT'L SA414-G EFF 85 %		SHIPPING WEIGHT: 109 LBS		QCM. APPL / DATE PE-1/16/2020	
SHELL THK: .125" NOM C.A.: --- MAT'L SA414-G EFF 70 %		VOLUME: 30 APPROX GAL		A.I. VERIFICATION / DATE BQ-1/16/2020	
NAT'L BD: Yes STAMP " U "		MAWP 150/FV PSI AT 400 °F		SAMUEL PRESSURE VESSEL GROUP	
MDMT -20 °F AT 150/FV PSI		TEST: HYDRO AT 195 PSI		OAKVILLE, ONT LEBANON, VA	
CRN: NONE		TEST: PNEU AT 195 PSI		DRAWN BY: IDV/SA P/N V10094	
DATE: 1/8/2020		PAGE 1 OF 2		REV. 0	